

Welcome to Expo Narrow Gauge[®] 2012

We hope that you will enjoy your day

The show is open from 10.00am to 5.00pm

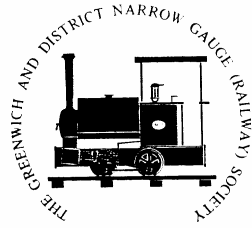

Welcome again to Swanley and this year's Expo Narrow Gauge. As ever, we have worked hard to bring you the best in narrow gauge modelling from across Britain and our friends on the continent and this year we again have over seventy stands. We all hope that you will find something of interest amongst the exhibits.

MOMING'12 @ ExpoNG

This year we welcome MOMING'12@ExpoNG – an 'exhibition with an exhibition', featuring layouts, demonstrations and traders celebrating the best in modelling minimum gauge railways.

Refreshments are available in the main leisure centre complex. Please retain your ticket as readmission can only be allowed on presentation of a valid ticket. If you have any questions, please ask at the G&DNRS stand (number one), or anyone wearing a Steward's badge.

Cameras may only be used within the exhibition halls. **Photography is STRICTLY FORBIDDEN in any other part of the Leisure Centre – anyone found using a camera outside of the ExpoNG halls will face the consequences of their actions.**

PLEASE ASK BEFORE TAKING PHOTOGRAPHS OR VIDEOS – it is only courteous, and camera flashes and video cameras can often have an adverse effect on operation!

Exhibitors are pleased to answer questions about their work, but please wait until a suitable break in operation so as not to disturb their concentration.

The winners of our two annual trophies and competition will be announced at around 3.00pm.

The David Lloyd Memorial Trophy is awarded jointly by the G&DNRS, the 009 Society and the 7mm NGA, and The Reinier Hendriksen Trophy is awarded by the RACOONS Group. Both are awarded for excellence in narrow gauge modelling. Last year's winners were Rod Allcock for 'Corris 1930' and Matthew and Helen Kean for 'Garreg Wen'.

Our Annual Competition has been renamed in honour of our late Chairman, David Brewer, who sadly passed away in 2008. This year our theme has been the Pizza layout and we have had a good number of entries register. We hope that they are all on display today.

1) Greenwich and District Narrow Gauge Railway Society

www.gdngrs.com www.expong.org

2) Slim Gauge Circle

www.slimgaugecircle.com

3) Clydach

4mm scale, 9mm gauge

Richard Holder

Clydach represents a fictitious preserved tourist railway situated on the coast of North West Wales. Construction of the Clydach Railway, or the Aberclydach and Borthwynog Light Railway as it was originally known, started in 1896. The first section completed carried slate, which was mined in the mountains above Borthwynog, further along the Clydach Valley, to the port of Aberclydach at the mouth of the estuary. The line was later extended and passengers were carried for the first time in 1924. The Clydach Railway Preservation Society took over the ownership of the railway in June 1954. The railway re-opened, after a brief period of closure, under the control of the Society at Easter 1955.

A wide variety of stock is run on the layout representing a variety of narrow gauge lines. Locomotives include a number of Garratt articulated designs.

4) Kingsbury Narrow Gauge

3 Sherbrooke Close, March, Cambridgeshire, PE15 9QJ
01354 650987 www.kingsburynarrowgauge.co.uk

5) Draig Goch

4mm scale, 9mm gauge

Darren Hedges

Draig Goch is one end of a fictional two foot gauge railway somewhere in North Wales. In the late 1880's local quarry owners got together to build a railway from the coast up the valley serving several slate and granite quarries, along with a couple of copper and lead mines. Narrow gauge was chosen to reduce costs and it was decided from the outset that a passenger service would be provided for the local population.

The railway and the quarries it served were moderately successful until the late 1940s when the area fell on hard times. With the steady closure of the quarries the railway found it harder and harder to make ends meet. With the line facing total closure in 1955 a group of enthusiasts from the North West and Yorkshire Inspired by the unexpected success down at the Tallylyn Railway formed a preservation society with the aim of keeping the railway open.

It has now been several years since this group took over operations and the line has gone from strength to strength. The local coal merchant is also a supporter of the railway and still has his supplies delivered by rail for distribution locally by road.

The layout consists of a terminus station with platform and loop, and sidings serving a goods shed and coal yard. A three road sector plate is provided for the fiddle yard. The period is the late 1950s early 1960s, with coal and tourists being the main business of the railway.

6) Penrhyn Railway Society

www.penrhynrailway.co.uk

7) 7mm Narrow Gauge Association and Sales

www.7mmnga.org.uk

8) Blackham Transfers

9 Benar View, Blaenau Ffestiniog, Gwynedd LL41 3UT
01766 832003 www.blackhamtransfers.com

9) Parkside Dundas

Millie Street, Kirkcaldy, Fife KY1 2NL
01592 640896 www.park-sidedundas.co.uk

10) A1 Models

46 Bawtry Road, Doncaster, DN4 7AZ 07584 620638

11) Atlantic Publishers

83 Parkanaur Avenue, Southend on Sea Essex SS1 3JA
01702 580409 www.atlanticpublishers.com

12) End of the Line

7mm scale, 14mm and 32mm gauges

Giles Favell

The End of The Line represents the transfer point of a very small coal mining operation, somewhere in the West Midlands area, in the early 1960's. Never very busy, the output of the mine is now divided between distant industry, transported by British Rail - when it remembers - and local demand, delivered by local road haulage.

The layout came about for two reasons. First, I wanted to try my hand at 0-14, which has some delightful kits now available and, second, I had built a Radio Controlled Truck in 7mm scale, and wanted to see if it were viable to have an integrated operation between road and rail. We'll see if it works!

Most of the 0-14 stock comes from the excellent stable of KBScale hits, including the tipper wagons, which have proved to be quite capable of reliable practical operation. The track is also built from KBScale parts. The Standard Gauge is based on Peco track, with C&L parts contributing to the point-work.

The layout is entirely DCC, controlling Tortoise point motors, together with the conveyor (converted Hornby). The R/C Truck is a converted Corgi Vanguard's Morris Commercial, with a Ipod Nano battery, and a Micron Tiny Receiver/speed controller - about the size of a small decoder - under the bonnet, with a single miniature servo for steering.

13) ABS Models / Wrightlines

39 Napier Road, Poole, Dorset BH15 4LX 01202 672891

14) The 009 Society

www.009society.com

15) Jonathan Clay Transport Art

28 San Juan Court, Eastbourne, East Sussex BN23 5TP
01323 478665 07709 973928 www.jonathanclay.co.uk

16) Model Railway Press

17) Eileen's Emporium

Unit 19, 12 Highnam Business Centre, Newent Road, Gloucester GL2 8DN
01531 828009 www.eileensemporium.com

18) 5.5mm Narrow Gauge Railway Association

<http://www.blackhamtransfers.com/55/5andahalflogo.html>

19) CWRailways

The Shires, Gloucester Road, Corse, Gloucestershire GL19 3RA
01452 849051 www.chrisjward.co.uk

20) S & D Models Highbridge Works, PO Box 101, Burnham on Sea TA9 4WA
01278 781603 www.sanddmodels.co.uk

21) Steve Currinn Books 77 Redwood Road, Kings Norton, Birmingham B30 1AE
0121 680 01444 07796 863249

22) Foxcombe Colliery 4mm scale, 9mm gauge **Phil Farr Cox**

Foxcombe Colliery is located near the fictional Somerset village of Foxcombe. The mine complex has a 2ft 3in narrow gauge railway to transport the coal towards the Somerset and Dorset main line. The layout depicts the Colliery in the late 1940s, after the acquisition of a variety of stock, including some from other collieries now worked out and closed. This was my first narrow gauge layout, built some six years ago to practise scenic techniques. It has been very educational, and there have been some changes and improvements along the way!

23) Corris Railway Society www.corris.co.uk

24) David Provan 9 Maple Close, Botley, Oxfordshire OX2 9DZ
01865 725347 david.provan@btinternet.com

25) Larkford 7mm scale, 16.5mm gauge **Stuart Marshall**

The layout depicts a small terminus on a branch of the Lark Valley Railway, a narrow gauge railway of 2ft 3in gauge. Set in the early 1920's before the onslaught of motor lorries and buses which would eventually cause the demises of the line. The LVR caters mainly for agricultural traffic with vegetables and fruit in season as well as milk travelling onwards to the standard gauge railway for shipment to major towns. Inbound traffic comprises of general merchandise, seed and coal. Apart from industrial use narrow gauge railways serving mainly agricultural communities were rare in this country - the Welshpool & Llanfair Light Railway being one of them. The advantage of railway modelling is that you can create your own little history without stretching probability too much.

Rolling stock is mainly second hand Peco painted and lettered with some new stock from Peco and Smallbrook Studios. The locomotives are from Peco and Smallbrook.

26) Worsley Works 19 Douglas Road, Worsley, Manchester M28 2SR
www.worsleyworks.co.uk

27) Gramodels 18 Lower Tail, Carpenders Park, Watford WD19 5DD
www.gramodels.co.uk

28) Dave Brewer 'Pizza Layout' Challenge Entries – see more in the squash court, stand 73

29) Lynton & Barnstaple Railway Association www.lynton-rail.co.uk

30) Zebediela Citrus 4mm scale, 9mm gauge **Des Trollip**

Zebediela Citrus - sized to fit inside three 'Really Useful' boxes - attempts to capture the atmosphere of an agricultural line from estate packing sheds through orange groves to

Sports Hall

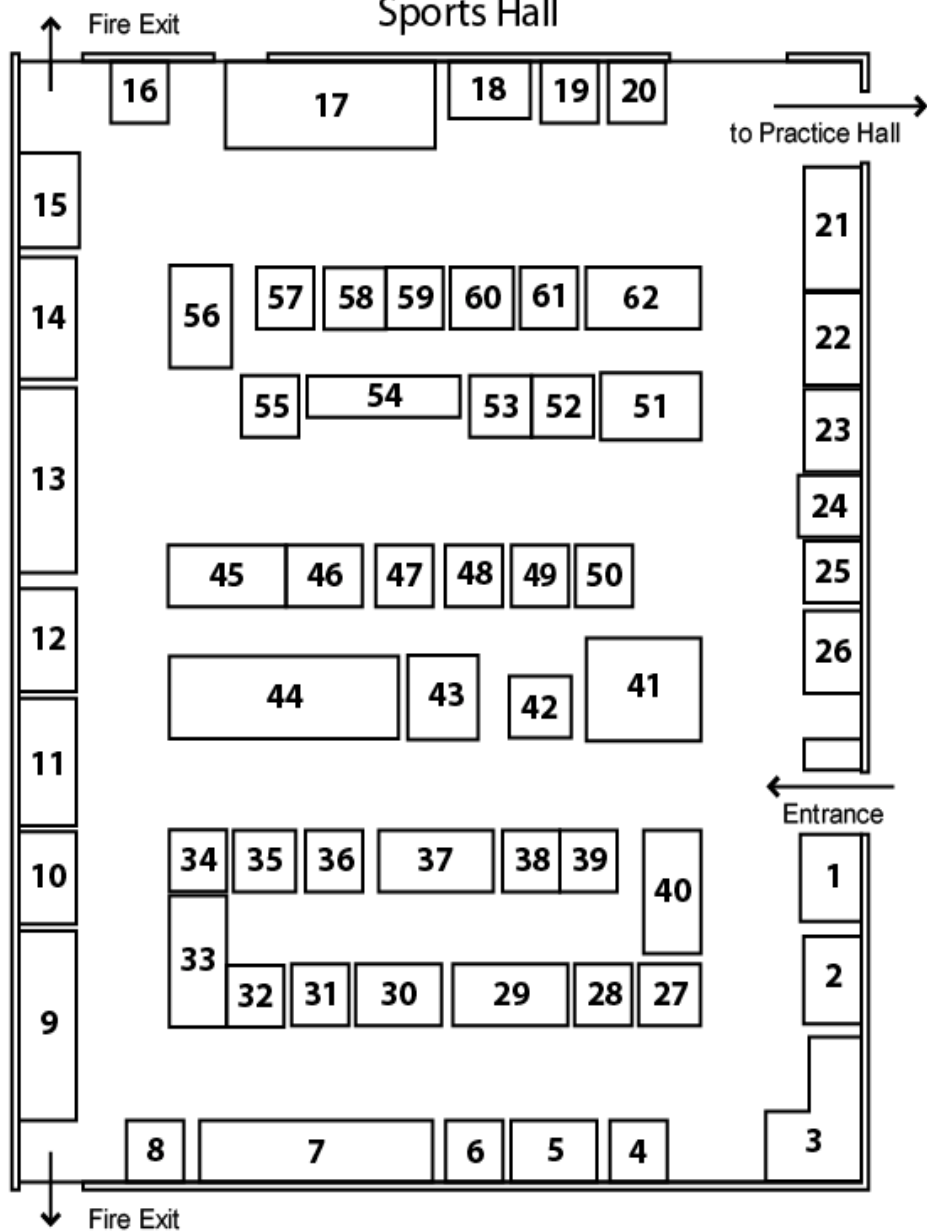

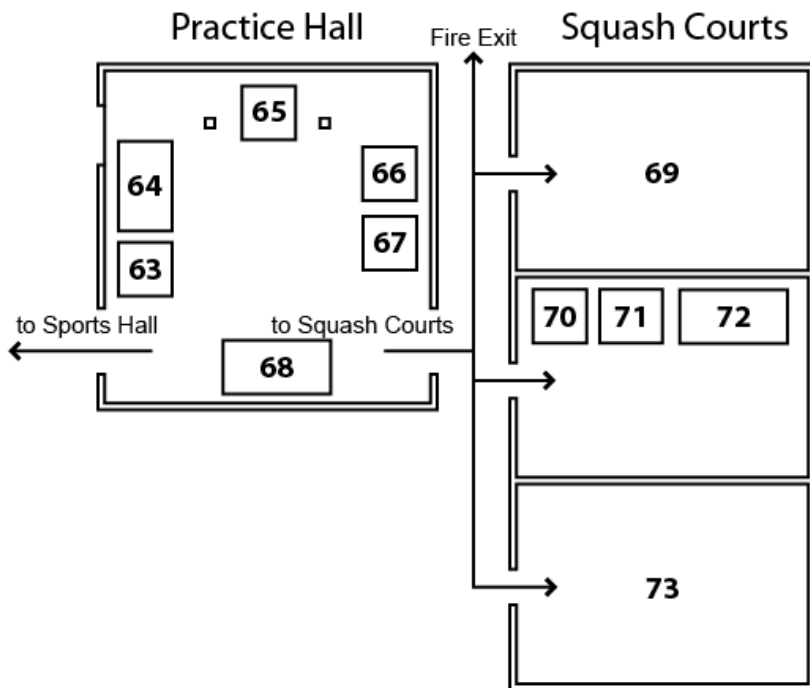

Access Routes

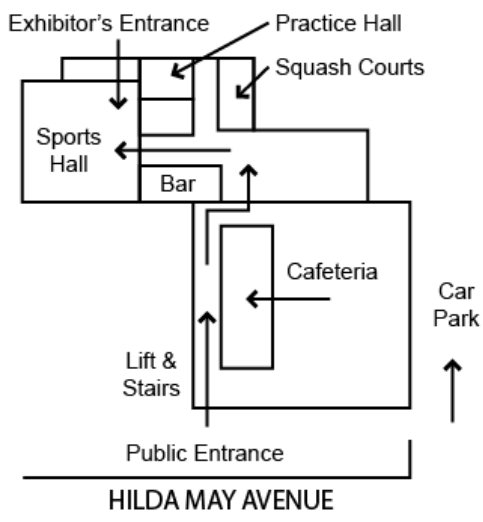

transshipment sidings, had it continued into the 1970's.

Based on Zebediela Estates, once the biggest citrus plantation in the Southern hemisphere, the estate covers 13,750 hectares. It was begun in 1917 and is 50 km outside Potgietersrus in Limpopo Province, South Africa (formally the Northern Transvaal),.

Between 1929 and 1930, three 4-4-0 "Lawleys", from the original narrow gauge 2ft gauge Beira Railway (which was constructed between 1895 and 1897 and converted to 3 ft. 6 in. in 1900) went to Zebediela Citrus Estates and continued to give good service there until about 1960 when the Estates went over to road transport.

Very little information is available about the Zebediela Estates Railways, it is estimated there was up to 40km's of 2ft track laid in the estate and to the transshipment link with the 3ft 6in mainline.

31) James Coldicott 1:32 Bucklands House, East Quantoxhead, Somerset TN5 1EH
01278 741212 www.james-art.com

32) Plateway Press Taverner House, Harling Road, East Harling, Norfolk NR16 2QR
01953 717498 www.plateway.co.uk

33) Andrew Neale Books
Chestnut Farm, Grayingham Cliff, Gainsborough, Lincolnshire DN21 4FL 01652 649409

34) Narrow Gauge & Industrial Railway Modelling Review
Greystar Publications, 66 High Street, West Wrattling, Cambridge CB21 5LU
01223 291442 www.narrowgaugeandindustrial.com

35) Dorset Kits 8 Southwood Close, Ferndown, Dorset BH22 9HW
01202 875570 kevintrim@btinternet.com

36) Castle Wharf Kendal 4mm scale, 9mm gauge **Ian Kirkwood**

Plans were produced by Col Stephens for a standard gauge light railway running south east from Canal Head in Kendal, Westmoreland to Arkholme, serving various quarries and gunpowder works, as well as local farming interests, but the scheme failed for lack of money. I have supposed that a narrow gauge line - a much cheaper option - was built.

The layout is a 009 model of the northern terminus in its later years. The canal is little used, most traffic being transferred to the LMS at exchange sidings just east of the area modelled. Trains to and from the exchange sidings are shunted at the wharf.

The non-railway buildings (all hand-made from card) are based on actual buildings from Kendal. The carriages and wagons are from kits and the locos are mainly from the excellent Backwoods Miniatures range of kits.

37) Moseley Railway Trust & Narrow Gauge Railway Society www.mrt.org.uk www.ngrs.org

38) KBscale 10 Longsdon Way, Caterham, Surrey, CR3 6BN
01883 335846 www.kbscale.com

39) Narrow Planet

First Floor, The Old Bakery, 17a Silchester Road, St Leonards-on-Sea, East Sussex TN38 0JB
www.narrowplanet.co.uk

40) Meridian Models

40 Moreland Avenue, South Benfleet, Essex SS7 4HB
01268 756110 www.meridianmodels.co.uk

41) Bouvier's Peak

1/4in scale, 16.5mm gauge

Brian Daly

The San Juan extension of the Denver and Rio Grande West (D & RGW) Narrow Gauge reached Durango in 1881. A line was built north from Durango to Silverton, which still exists today and forms the World famous Durango & Silverton Railroad. The period for the layout is set from the 1930's until the 1950's. The Rio Grande Southern (RGS) also connected at Durango. The RGS mainline ran from Durango to Ridgway, where it again connected to the D&RGW, forming the Narrow Gauge circle - a round trip of approximately 1000 miles.

The Local logging company, the Rio Florida Logging Company or RFLC runs a large network of lines around Bouviers Peak. It should be noted that the RFLC has running rights on the D&RGW and RGS. It connects with them at Simpson's Peak and at Baldy Peak. Stock from all companies can be seen at all locations and some mixed running is common.

Bouviers Peak is the motive power base for the Rio Florida logging Company and its sometimes strange buying practices can be seen here. The small depot serves the local town with all of its needs and small wagon loads are often seen by the depot building. The line also provides passenger services to the logging camps and to the rest of Colorado.

DCC is used to control the whole layout, there is no control panel. A PC is connected to the DCC system to allow the use of ITouches and iPhones to control the layout using WIFI, this gives more flexibility.

42) Golden Arrow Productions

392 Harold Road, Hastings, East Sussex TN35 5HG
01424 445334 www.goldenarrow.me.uk

43) Port Wynnstay Models

20 Willson Road, Littleover, Derby DE23 1BZ
01332 774616 www.portwynnstay.co.uk

44) EDM Models

19 Briar Avenue, Acomb, York YO26 5BX
01904 331973 (evenings) www.ngtrains.com

45) Backwoods Miniatures

11 Netherton Southside, Netherton, Morpeth, Northumberland NE65 7EZ
01669 630255 www.backwoodsminiatures.com

46) Banta Modelworks

421 Hopkins Road, Dummerston, Vermont 05301, USA
001 802 258 3869 www.bantamodelworks.com

47) Two Sisters Farm

1/32nd scale, 16.5mm gauge

Peter Marshall

The layout depicts a fictitious two foot narrow gauge light railway serving a large agricultural estate in the Lincolnshire fens in the late fifties. It is very loosely based on a similar railway

that actually existed from the 1920s until the late 1960s and was some 22 miles long in total. It was originally powered by horses but in later years steam, petrol and diesel locomotives were also used. The light railway was used to bring the crops (mainly potatoes - both early and main-crop) but also wheat and sugar beet from the fields to either a standard gauge railhead interchange or to be loaded onto lorries for transport to market.

The model features the small terminus at Two Sister's Farm, the largest of several farms that make up the estate. There is a small engine shed with minimal facilities for coaling watering and servicing the small but varied fleet of locomotives and rail trucks. There is also a small workshop where tractors and implements for the whole estate are serviced and repaired.

The main crop grown on the estate is potatoes, for a crisp manufacturer in one instance, but the need for crop rotation and the varying soils mean that wheat and sugar beet are also grown. In addition to arable farming cattle pigs and sheep are also reared to give diversity. There is a small area of woodland which provides the estate with all its timber needs and allows the breeding of game birds for the occasional shooting party.

Wagons are pushed in to the small yard from the outlying fields and trains are then made up for sending to the standard gauge connection nearby. Rail trucks are used to take out fuel, seeds and fertiliser to the fields.

48) Amberley Museum and Heritage Centre

www.amberleymuseum.co.uk

49) Roxey Mouldings

58 Dudley Road, Walton on Thames, Surrey KT12 2JU
01932 245439 www.roxeymouldings.co.uk

50) Pontevedro

3.5mm scale, 9mm gauge

Don Sibley

Some of you (if you are old enough!) may remember my original layout of the same name, built in the 1970s. It was my first attempt at an HO layout and after several years of exhibitions the home built points became unreliable. At that stage I rebuilt it, half the size, with a plywood cover for transport and storage, so it was easy and quick to set up at one day exhibitions. So it survives and is stored in my loft.

Pontevedro is a small principality somewhere in Eastern Europe. The Pontevedrian Embassy is the scene for the Lehar opera "The Merry Widow". The rolling stock of the Pontevedrian Steam Tramway was obtained secondhand from all over the world, so you are likely to see the most impossible combinations of locos and coaches.

The model has hand built track, but buildings and rolling stock are a mixture of hand built, kit built and commercial models.

51) Brink Valley Tramway

7mm scale, 9mm gauge

Christopher Payne

After a decade thinking about using O9 to portray an 18in minimum gauge line, the BVT was built for the Wealden Railway Group's 2010 design competition. An operating layout in the area of three sheets of A4 paper (885mm x 209mm - approx 35in x 8.25in), with between three and six points, and an "off stage" A4 length of track was permitted in any scale and gauge. Subsequently a somewhat complex fiddle yard has been added which will also be used for a future project.

Three locomotives use Bachmann Plymouth MDT chassis, No 2 (the "signature loco") being developed from a Hornby "Smokey Joe" moulding. The fourth loco has a Fleischmann chassis. Rolling stock is scratch built or modified from Avalon Line kits running on Peco chassis. The station building began life as an Airfix 4mm scale coal office, the water tower is scratch built, and the "BQCo" shed is a balsa clad styrene shell. The trees were supplied from France by Jacky Molinaro.

Traditional wisdom says that as one gets older it is a good idea to change to modelling in a larger scale. After many years using 1:34 and 1:25 scales this view has proved easy to confound.

52) Black Dog Mining Company 95 King Arthurs Road, Exeter, Devon EX4 9DS
01392 410796 www.pepper7.co.uk

53) Avalon Models 11 Hood Close, Glastonbury, Somerset. BA6 8ES
01458 830542 (w/ends) 01646 636909 (Mon-Thus) www.theavalonlinemodels.co.uk

54) Hook Basin 1/25th scale, 16.5mm gauge **Richard Williams**

An 18in gauge rural Tramway, the line as seen represents a period in the early 1930s, somewhere near the ironstone deposits of North Oxfordshire.

The canal is a spur from the Oxford Canal to feed the northern area of the Cotswolds. This links the fertile farmland and ironstone quarries with the industrial Midlands.

Since being seen at ExpoNG last year, the layout has been extended by the addition of the Station, and a new fiddle yard. This completes the project as originally planned, and a new layout is in development.

55) MOMING Modelling Demonstration **Chris Krupa**

56) Briquetterie St Aubin 1/24th scale, 16.5mm gauge **Jacky Molinaro**

57) Yellow Ridge Mine 1/24th scale, 16.5mm gauge **Nick Wright**

This layout is set in the 1970s and depicts a small Uranium mine somewhere in the Canada. Although the layout is not based on an actual prototype, I have tried to capture the industrial 'run on a shoe- string' look and feel of a typical mine of this size

58) Mercian Models 1A Market Way, Hagley, Stourbridge, West Midlands DY9 9LT
01562 884800 www.modelrailways.tv

59) Minimum Gauge Models 63 Church Street, Halesowen, West Midlands B62 9LQ
07812 189037 www.mgmodels.co.uk

60) Moor End Lane Works 7mm scale, 9mm gauge **Tim Tinnckell**

Moor End Lane Works is the engineering facility for the Specialist Mining Company. It is situated in a former mineral extraction site worked out many years earlier. The current

mining operation takes place to the east of the site, the processing works to the west.

Work undertaken on this site consists of major wagon repairs, locomotive repairs and assembly of prefabricated track panels for the underground sections.

The layout is built to O9 scale, using 9mm gauge track and 7mm scale to represent an 18 in gauge industrial railway. Track is Peco 009, locos are built on N gauge chassis, wagons are kit built from Avalon and Black Dog kits.

61) Badgers Bottom and the Orchard Line **1/20.3 scale, 9mm gauge** **Simon Andrews**

Details of this layout can be found in the latest issue of "Narrow Gauge and Industrial Railway Modelling Review", available from Stand 34.

62) Smallbrook Studio

Smallbrook House, Gunville West, Newport, Isle of Wight PO30 5LW
01983 520584 www.smallbrookstudio.com

63) N-Drive Productions 07778 640336 www.n-driveproductions.com

64) Snipe End Farm **7/8th inch scale, 45mm gauge** **Steph Hicking**

Snipe Fen Farm is built to the scale of 7/8ths of an inch to the foot (1:13.7) and inspired by the number of small agricultural narrow gauge lines that dotted the fens in the east of England at the turn of the 20th century, especially after the First World War, when large amounts of War Department two foot gauge stock and rail were being disposed of. Lincolnshire was the main location where these lines were utilized, as they gave a reliable method of accessing the sometimes muddy and unstable fields where the potato crops etc were grown.

With Snipe Fen Farm I imagine that one of these lines lasted longer than the others (most were gone by the late 1940s), and is still in use closer to the present day. I keep the timescale vague deliberately to enable a variety of stock to be run! Rivet counters beware - I often aim for atmosphere and overall look, rather than true scale models - although a few of those may appear!

As can be seen by the bare trees and Daffodils, the railway is set just at the start of spring when things are starting to awaken after the long bleak winter.

One unusual feature is that, as 7/8ths is more generally a "garden railway scale" rather than an indoor layout one, the locomotives are all battery powered and driven by controls on the locomotives themselves rather than track powered or the like.

65) Ceynix Railway Trees 18 Petts Hill, Northolt, Middlesex, UB5 4NL
0208 864 6596 www.railwaytrees.co.uk

66) Vroonen **3.5mm scale, 9mm gauge** **Dick Van Beek**

It's a nice day in Vroonen in the 1930s and everyone wants to go to the beach at Santmond and to other places, and they will take the bus or tram.

